

Stand Map
WY - Madison
Parcel # 28089Hb0011
 Madison County, MS - approx. 452.0 acres +/-

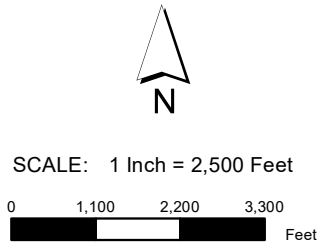
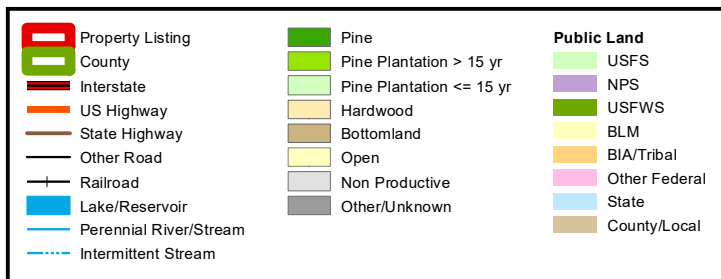

Stand #	Cover Type	Age	Acres
NP	Non Productive	NA	8.2
1	Pine Plantation <= 15 yr	0	264.8
2	Hardwood	69	85.3
5	Hardwood	69	81.9
11	Hardwood	69	3.8
16	Pine Plantation > 15 yr	20	5.1

Smaller stands have been excluded to fit in the allowable space

The property depicted on this map has not been surveyed. The acreage is an estimate based upon GIS data. The volume information in this report is based on current information in the seller's inventory system. The information is subject to change due to harvest activities and/or updates resulting from routine maintenance of the inventory system. Neither the owner nor its officers, directors, employees or agents represent or warrant the accuracy or completeness of the ownership acreage, the cover type acreage, timber inventory species, grade or volumes, legal or practical access to the property, or operability. 3/11/2021