

Stand Map
Lunsford Rd
Parcel # 28069Hb046
 Kemper County, MS - approx. 61 acres +/-

Stand #	Cover Type	Age	Acres
NP	Non Productive	NA	4.2
1	Pine Plantation <= 15 yr	3	53.4
3	Hardwood	72	2.1

Property Listing	Pine	USFS
County	Pine Plantation > 15 yr	NPS
Interstate	Pine Plantation <= 15 yr	USFWS
US Highway	Hardwood	BLM
State Highway	Bottomland	BIA/Tribal
Other Road	Open	Other Federal
Railroad	Non Productive	State
Lake/Reservoir	Other/Unknown	County/Local
Perennial River/Stream		
Intermittent Stream		

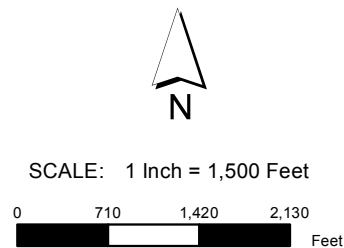

The property depicted on this map has not been surveyed. The acreage is an estimate based upon GIS data. The volume information in this report is based on current information in the seller's inventory system. The information is subject to change due to harvest activities and/or updates resulting from routine maintenance of the inventory system. Neither the owner nor its officers, directors, employees or agents represent or warrant the accuracy or completeness of the ownership acreage, the cover type acreage, timber inventory species, grade or volumes, legal or practical access to the property, or operability.